

PRE-OWNED COACH

2010 Marathon Coach #1185

PREVOST H3-45 TRIPLE SLIDE



www.marathoncoach.com



MARATHON COACH PRE-OWNED INVOICE

1185 EXV3SF CONSIGNMENT

VIN # 2PCV334958C711334

YEAR: 2010

Shell Specs

Converter: MARATHON COACH
Shell Type: PREVOST
Motor: DETROIT DIESEL SERIES 60
Transmission: ALLISON SIX SPEED
Mileage: CALL FOR CURRENT MILEAGE
Jacobs Brake / Retarder: JACOBS BRAKE
O. T. R./ Drivers A C: DRIVERS A/C
Tires: MICHELIN
Exterior Colors: BLACK, SAND, RED APPLE

Interior Specs

Interior Colors:
Floorplan: OFFSET AISLE, SPLIT GALLEY
Bed Arrangement: CROSS JR KING
Cabinet Color: AUTUMN & NATURAL TIGRIS
Counter Color: CANELA STONE & LATTE
Carpet Color: BAYSHORE & CREMA

ADD'L INFO AVAILABLE AT
WWW.MARATHONCOACH.COM

Equipment Listing

Interior

LEATHER PILOT & COPILOT CHAIRS
 SHARP AQUOS TV IN SALON/COCKPIT
 CARPET FLOORING IN SALON
 LEATHER RECLINER WITH OTTOMAN
 LEATHER SLEEPER SOFA
 SHART TV IN CURIO CABINET
 L-SHAPED LEATHER DINETTE
 TILE GALLEY FLOORS WITH KEYS
 GAGGENAU ELECTRIC COOK TOP
 GE ADVANTIUM SPEEDCOOK MICRO/OVEN
 KITCHEN AID SIDE BY SIDE
 FULL BATHROOM WITH SECOND VANITY
 ASKO STACKED WASHER AND DRYER
 TWO BEDROOM WARDROBE CLOSETS
 CARPET FLOOR IN MASTER SUITE
 MAKE-UP COUNTER & STOOL
 REAR WALK IN CLOSET
 DISH NETWORK HD RECEIVER
 SONY BLU RAY PLAYER
 CRESTRON AUDIO/VIDEO CONTROLS
 TECH LINK MONITORS
 TRAILER BRAKING SYSTEM

Exterior

CUSTOM MARATHON PAINT SCHEME
 RAMCO SIDE VIEW MIRRORS
 THREE BODY SLIDE OUTS (TWO IN FRONT)
 SIDE VIEW CAMERAS
 BACK UP CAMERA
 TOW HITCH
 PAINTED SLIDE OUT ENDS
 CHROME WINDSHIELD WIPER ARMS
 KEYLESS ENTRY
 FOUR ROOF MOUNTED AIR CONDITIONERS

MATCHING TRAILER SOLD SEPERATELY

Underbelly

ELECTRIC BAY DOOR LOCKS
 CARPETED AND INSULATED STORAGE
 STORAGE FLOOR MAT IN BAY ONE
 MANUAL BAY SLIDE OUT IN BAY TWO
 KOHLER 20 KW GENERATOR
 BAY ENTERTAINMENT CENTER
 SHARP TV WITH STEREO SPEAKERS
 ORIGINAL MARATHON MATS & CHAIRS
 PLUMBING BAY WITH WSH STATION

Tank Capacities

FUEL CAPACITY	<input type="text" value="235 GALLONS"/>	FRESH TANK CAPACITY	<input type="text" value="165 GALLONS"/>
LP GAS CAPACITY	<input type="text"/>	GREY TANK CAPACITY	<input type="text" value="94 GALLONS"/>
		BLACK TANK CAPACITY	<input type="text" value="60 GALLONS"/>

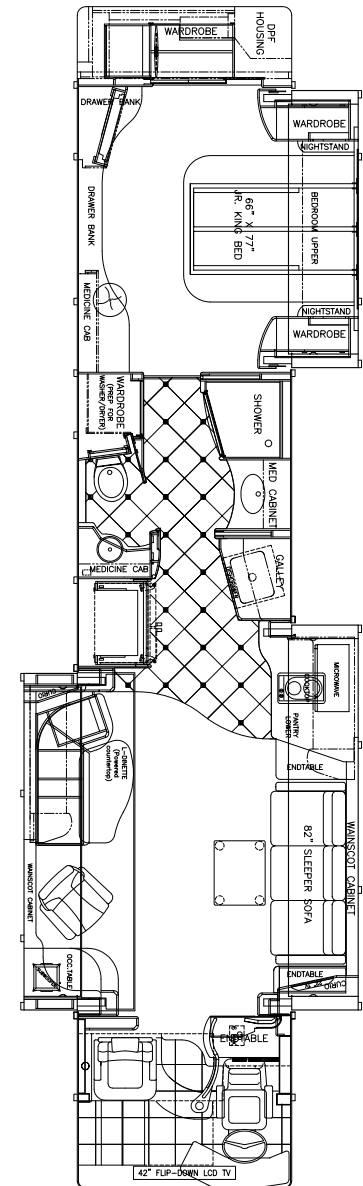

All Prices And Options Are Subject To Change Without Notice.
Although We Try To Provide Accurate Information, It Is Not Guaranteed. Equipment Important To The Customer Should Be Personally Verified.